

CSP2-BU Series

LED Flush Mount Downlight with Emergency Battery Backup

Fixture Type:
Project Name:
Location:
Date:

Features

- 7"/9" slim flush mount downlight
- Built-in test button
- Suitable for 12W emergency battery Jbox
- 3CCT color temperature adjustable 30/40/50K
- Polycarbonate engineering plastic housing
- Durable polycarbonate Lens
- Triac dimming
- Suitable for damp location
- Easy installation for flush mount to most standard J-box

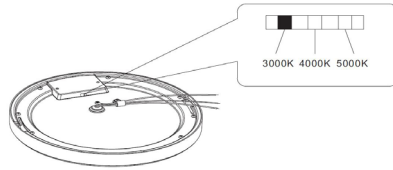

Product Performance Standard

Size	7"/9"	Power Factor	90%
Weight	0.6lb/1lb	Life Span	50,000 Hrs
Mounting	Flush Mount	Dimmable	Triac Dimming
Color Temp	3CCT	Efficacy	Up to 80 lm/W
CRI	80	Warranty	5 Years
Input Voltage	120V	Ambient Operation Temperature	-15°C (-4°F) ~ 40° (104°F)

Dimensions

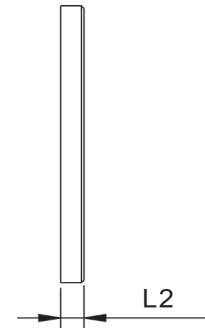
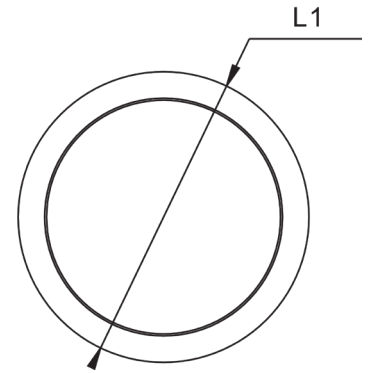

	12W	18W
L1	7.09"	8.86"
L2	0.75"	0.75"

Ordering Guide

Example: CSP2 7IN15W 3CCT

Fixture Type	Size & Wattage	Color Temp.	Voltage	Finish	EM Test Button	EM
CSP2	7IN15W = 7inch 15Watt 9IN18W = 9inch 18Watt	3CCT = 30/40/50K (Color Temperature Adjustable)	Blank = 120V	Blank = White	BU = Emergency Battery capable	EMJB-12W02 =Emergency JBOX

CSP2-BU Series

LED Flush Mount Downlight with Emergency Battery Backup

Fixture Type:
Project Name:
Location:
Date:

Product Information

		3000K		4000K		5000K	
WATTAGE	LUMEN	EFFICACY	LUMEN	EFFICACY	LUMEN	EFFICACY	
15W	900lm	75lm/W	936lm	78lm/W	960lm	80lm/W	
18W	1350lm	75lm/W	1404lm	78lm/W	1440lm	80lm/W	

Optional Accessories



Jbox Emergency Battery Backup

- SKU: EMJB-12W02
- Internal battery backup is field install
- Delivery up to 960 lumen for 90 minutes emergency operation

For the accessories detail, please visit www.lironlighting.com/product_categories/add-on-accessories