

Installation Guide

IMPORTANT SAFETY INFORMATION

- WARNING : RISK OF SHOCK** House electric current can cause painful shock or serious injury unless handled properly. For your safety, always remember to :
A : Turn off the power supply at the fuse or circuit breaker box before you install the fixture.
B : Ground the fixture to avoid potential electric shocks and to ensure reliable starting.
C : Double-check all connections to be sure they are tight and correct.
D : Wear rubber soled shoes and work on a sturdy wooden ladder.
- This fixture is designed for use in a circuit protected by a fuse or circuit breaker. It is also designed to be installed in accordance with local electrical codes. If you are unsure about your wiring, consult a qualified electrician or local electrical inspector, and check your local electrical code.
- WARNING : RISK OF CUTS** Some metal parts in the fixture may have sharp edges. To prevent cuts and scrapes, wear gloves when handling the parts.
- Account for small parts and destroy packing material, as these may be hazardous to children.

Product Specification

Size	Wattage (W)	Voltage (V)	Rated Input Frequency (Hz)	Dimension (DxH)
4 in.	10W	AC120V	50/60Hz	Φ147x26mm
6 in.	15W			Φ190x29mm
8 in.	20W			Φ214x35mm

Surface Mounting Installation

3.5"/4"/5"/6" Junction Box

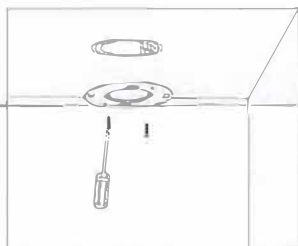

1. Install the mounting bracket on the ceiling junction box with two screws.

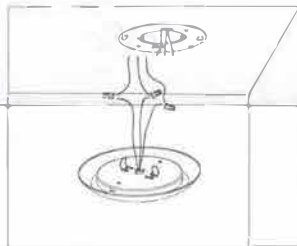

2. Connect the wires by using the wires nuts

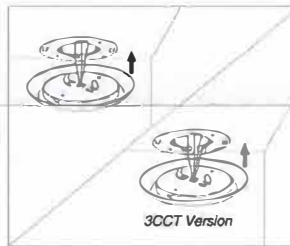

3. Push all connected wires (also 3CCT button and connected wire for 3CCT version) into the junction box with caution. Fit the luminaire with the ceiling mounted bracket.

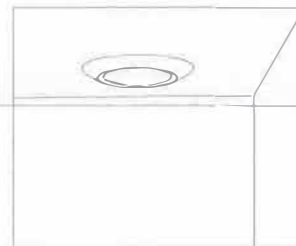

4. Apply power.

Embedded In Installation

5"/6" Can

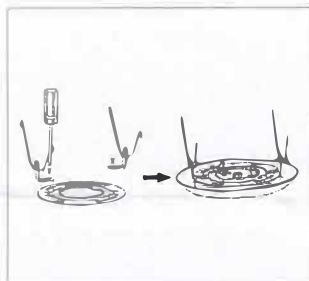

1. Install the clips on the mounting bracket with two screws. Rotate the mounting bracket to fit on the luminaire.



2. Screw E26 socket adapter into socket in the housing. Connect the wires by using the wires nuts



3. Push all connected wires (also 3CCT button and connected wire for 3CCT version) into the housing with caution. Press the friction blade to insert the luminaire.

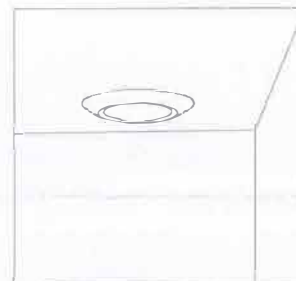

4. Apply power.

Caution

- WARNING : Risk of fire.** Use AC120V 50/60Hz circuits.
- Suitable for wet locations. Before installing your lighting fixture, thoroughly review enclosed installation manual. If you do not have sufficient electrical wiring experience, please refer to a do-it-yourself wiring handbook or have your fixture installed by a qualified licensed electrician. All electrical connections must be in accordance with local and National Electrical Code(NEC) standards. Reliable operating temperature is -20 to +40 degrees Celsius(-4 to +104 degrees Fahrenheit).
- pls obey fire prevention regulations, do not cover the fixture with any heat insulated materials.
- Do not change the LED light source or driver inside under any circumstance.

Warranty:
5 years warranty



This product is for indoor use only



For use with dimmers