

# LED

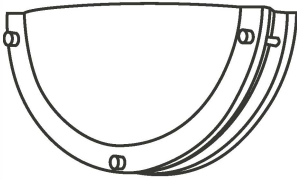

## INSTALLATION INSTRUCTIONS

### TROUBLESHOOTING:

- Check that line voltage at fixture is correct.
- Ensure that there is voltage at lamp fixture wires. If there is no voltage, then check all connections.
- Check that fixture is grounded properly.

### If fixture does not light:

- Check switch to ensure that there are no defects.
- Check fuse/circuit breaker for trips, then check wiring connections.

### CLEANING AND MAINTENANCE:

CAUTION: Ensure fixture temperature is cool enough to touch. DO NOT clean or perform maintenance while fixture is energized.

- Clean lens and fixture with non-abrasive cleaning solution.
- Do not open fixture to clean LED. Do not touch the LED.
- Do not spray liquid directly on to LED, LED driver or wiring.

### Please read carefully before installing fixture.

Save these instructions, as you may need them at a later date.

Please follow the following steps for installation. →

## WARNINGS:



Turn power off before installation, inspection, or removal. Use all necessary precautions while performing this procedure.



Consult a qualified electrician to ensure correct branch circuit conductor. Min 90°C supply conductors.



Properly ground electrical enclosure. IT IS IMPERATIVE THAT THE OUTLET BOX BE PROPERLY GROUNDED.



DO NOT REVERSE THE HOT AND NEUTRAL CONNECTIONS, OTHERWISE SAFETY WILL BE COMPROMISED.



This Integrated LED Fixture™ has no lamp/bulb to replace.

**GENERAL:** All electrical connections must be in accordance with local and National Electrical Code (N.E.C.) standards. If you are unfamiliar with proper electrical wiring connections, contact and obtain the services of a qualified electrician. Use UL or IEC approved wire only for input/output connections.

Remove fixture and mounting components from the box, and make sure that no parts are missing, by referencing the illustration in the illustration instructions.

**DIMMING:** This product is compatible with most common residential type dimmers. Dimming performance will depend upon dimmer, dimmer settings (dimmers with adjustments to brightness range), wiring method, and number of LED modules. For best results, set dimmer position at maximum before adjusting to a lower light level.

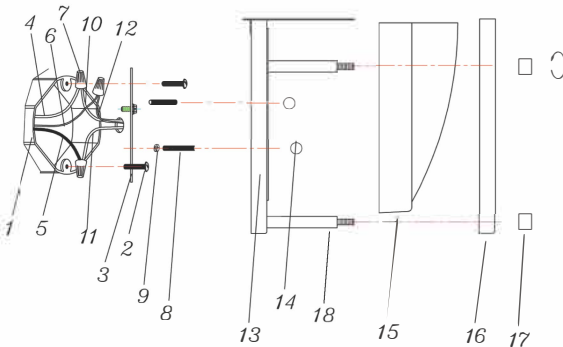

Figure 1

- |                              |                           |
|------------------------------|---------------------------|
| 1. OUTLET BOX (NOT INCLUDED) | 10. WHITE FIXTURE WIRE    |
| 2. MOUNTING SCREW            | 11. BLACK FIXTURE WIRE    |
| 3. MOUNTING BRACKET          | 12. FIXTURE GROUND WIRE   |
| 4. WHITE SUPPLY WIRE         | 13. FIXTURE BASE          |
| 5. BLACK SUPPLY WIRE         | 14. FIXTURE NUTS          |
| 6. SUPPLY GROUND WIRE        | 15. LENS COVER            |
| 7. WIRE NUTS                 | 16. DECORATIVE RING       |
| 8. FIXTURE SCREW             | 17. DECORATIVE NUTS x3pcs |
| 9. FIXTURE SCREW NUT         | 18. FIXTURE BASE SCREWS   |

## 5-YEAR LIMITED WARRANTY

**LIMITED WARRANTY:** Bright33™ Light Fixtures are warranted to be free and clear of defects in materials and workmanship for a period of five years from the date of purchase based on three hours of average usage per day for seven days a week. This warranty covers defects in manufacturing discovered while using the product as recommended by the manufacturer and does not apply to failures caused by acts of God or as a result of any abuse, misuse, abnormal use, or use in violation of any applicable standard, code, or instructions for use in installations.

If a Light Fixture fails due to a defect covered by this warranty, Stream33 Products LLC will either replace the product. To make a warranty claim, retain the failed products and send with proof of purchase, register receipt, your name and address to the following address within thirty (30) days of the failure



- 1 SHUT OFF MAIN ELECTRICAL SUPPLY FROM THE MAIN FUSE BOX/CIRCUIT BREAKER!
- 2 Remove contents from box. Ensure that no parts are missing. Reference the illustration included with this instruction manual.
- 3 Locate BLACK AND WHITE SUPPLY WIRES(4&5) and the SUPPLY GROUND WIRE(6), and remove them from the OUTLET BOX(1).
- 4 Attach the MOUNTING BRACKET(3) to the OUTLET BOX(1). Use the slotted holes on the MOUNTING BRACKET(3), and the included MOUNTING SCREWS(2).
- 5 Thread the FIXTURE SCREWS(8) through the threaded holes of the MOUNTING BRACKET(3). Make sure to allow both FIXTURE SCREWS(8) to protrude through MOUNTING BRACKET(3) holes.
- 6 Make the following wire connections (Fig.1), using the provided WIRE NUTS(7):  
WHITE (-) SUPPLY WIRE (4) TO WHITE FIXTURE WIRE (10)  
BLACK (+) SUPPLY WIRE (5) TO BLACK FIXTURE WIRE (11)  
SUPPLY GROUND WIRE (6) TO FIXTURE GROUND WIRE (12)  
If necessary, wrap all wire connections in electrical tape to ensure a secure connection.
- 7 Carefully tuck all wiring back into the OUTLET BOX(1).
- 8 Remove DECORATIVE RING(16) and LENS COVER(15) from FIXTURE BASE(13), by unscrewing DECORATIVE NUTS(17) from FIXTURE BASE SCREWS(18).
- 9 Align the FIXTURE BASE (13) over the mounting surface. Center the protruding FIXTURE SCREWS(8) from the OUTLET BOX(1), STEP 5, over the appropriate FIXTURE BASE(13) holes. Then, affix the FIXTURE BASE(13) to MOUNTING BRACKET(3) using the included FIXTURE SCREW NUTS(9) and FIXTURE NUTS(14). *Make sure to fasten tightly.*
- 10 Place LENS COVER(15) into slots on FIXTURE BASE(13), and DECORATIVE RING(16) over the FIXTURE BASE SCREWS(18). Secure both using the three included DECORATIVE NUTS(17).
- 11 Restore power at fuse box/circuit breaker. Check operation of Integrated LED Fixture™.
- 12 Installation complete.