

COLOR SELECTABLE LED EXIT SIGN

SAFETY AND INSTALLATION INSTRUCTIONS

⚠ WARNING

- Before installing, servicing, or performing routine maintenance upon this equipment, follow these general precautions.
- To reduce the risk of death, personal injury, or property damage from fire, electric shock, falling parts, cuts/abrasions, and other hazards, read all warnings and instructions included with and on the fixture box and all fixture labels.
- Power must be turned off at the breaker before installation or maintenance.
- Installation, service, and maintenance of luminaires should be performed by a qualified licensed electrician.
- Wear gloves and eye protection at all times while installing, servicing, or performing maintenance on the luminaire, and avoid direct eye exposure to the light source while it is on.
- Do not install damaged product. Inspect luminaire for damage that may have occurred during transit. If damaged, contact the manufacturer immediately.
- These instructions do not purport to cover all details or variations in equipment nor to provide every possible contingency to meet in connection with installation, operation, or maintenance. Should further information be desired or should particular problems arise which are not covered sufficiently for the purchaser's or owner's purposes, contact the manufacturer.

⚠ ADVERTENCIA

- Antes de instalar, reparar o realizar el mantenimiento de rutina de este equipo, siga estas precauciones generales.
- Para reducir el riesgo de muerte, lesiones personales o daños a la propiedad por fuego, descarga eléctrica, caída de piezas, cortes / abrasiones y otros peligros, lea todas las advertencias y instrucciones incluidas con y en la caja del dispositivo y todas las etiquetas del dispositivo.
- Se debe apagar la energía en el disyuntor antes de la instalación o el mantenimiento.
- La instalación, el servicio y el mantenimiento de las luminarias deben ser realizados por un electricista autorizado y calificado.
- Utilice guantes y protección para los ojos en todo momento durante la instalación, el servicio o el mantenimiento de la luminaria, y evite la exposición directa de los ojos a la fuente de luz mientras está encendida.
- No instale un producto dañado. Inspeccione la luminaria en busca de daños que puedan haber ocurrido durante el tránsito. Si está dañado, comuníquese con el fabricante de inmediato.
- Estas instrucciones no pretenden cubrir todos los detalles o variaciones en el equipo ni proporcionar todas las posibles contingencias a cumplir en relación con la instalación, operación o mantenimiento. Si desea obtener más información o si surgen problemas particulares que no están suficientemente cubiertos para los propósitos del comprador o propietario, comuníquese con el fabricante.

⚠ AVERTISSEMENT

- Avant d'installer, d'entretenir ou d'effectuer une maintenance de routine sur cet équipement, suivez ces précautions générales.

COLOR SELECTABLE LED EXIT SIGN

SAFETY AND INSTALLATION INSTRUCTIONS

- Pour réduire le risque de décès, de blessures corporelles ou de dommages matériels dus à un incendie, un choc électrique, des chutes de pièces, des coupures/abrasions et d'autres dangers, lisez tous les avertissements et instructions inclus avec et sur la boîte du luminaire et toutes les étiquettes des luminaires.
- L'alimentation doit être coupée au niveau du disjoncteur avant l'installation ou l'entretien.
- L'installation, l'entretien et la maintenance des luminaires doivent être effectués par un électricien qualifié et agréé.
- Portez des gants et des lunettes de protection à tout moment lors de l'installation, de l'entretien ou de la maintenance du luminaire, et évitez l'exposition directe des yeux à la source lumineuse lorsqu'elle est allumée.
- N'installez pas de produit endommagé. Inspectez le luminaire pour les dommages qui ont pu se produire pendant le transport. S'il est endommagé, contactez immédiatement le fabricant.
- Ces instructions ne prétendent pas couvrir tous les détails ou variations de l'équipement ni fournir toutes les éventualités possibles à rencontrer en rapport avec l'installation, l'exploitation ou la maintenance. Si des informations supplémentaires sont souhaitées ou si des problèmes particuliers surviennent qui ne sont pas suffisamment couverts pour les besoins de l'acheteur ou du propriétaire, contactez le fabricant.

CAUTION

- Equipment should be mounted where it will not be subject to tampering by unauthorized personnel.
- Do not mount near gas or electric heaters.
- The use of accessory equipment not recommended by the manufacturer may cause an unsafe condition.
- Do not use this equipment for any other purpose than its intended use.
- When re-lamping, use only LED lamps specified in the fixture. Using other lamp types may result in transformer damage or unsafe conditions.
- Use caution when servicing batteries. Battery acid can cause burns to skin and eyes. If acid is spilled on skin or eyes, flush acid with fresh water and contact a physician immediately.

NOTICE

- The battery in this unit may not be fully charged. After electricity is connected to the unit, let the battery charge up for at least 24 hours for normal operation of this unit to take effect.
- During an electrical power failure, the LED lamps will automatically come on for a minimum of 90 minutes. In accordance with NFPA 101, your emergency lighting system must be tested monthly for a minimum of 30 seconds and annually for 90 minutes. Refer to your local codes for any additional requirements that may apply.
- Press the TEST button to check proper workmanship. The lamps should illuminate when the TEST button is pressed.
- Apply AC power to the unit. The LED Indicator should turn RED.
- After the battery has been left to charge for 24 hours, test the unit by pushing the test switch. The LED Indicator turns OFF and the sign LED board stays ON. At the same time, twin lamp heads will turn ON.
- When the test switch is released, the sign LED board still stays ON and the LED Indicator turns back to RED. At the same time, twin lamp heads will turn OFF.
- Do not use outdoors.

Installation Instructions

Top Mount and End Mount

- Remove the faceplate(s) and lenses from housing and set aside (see Fig. A).
- Remove the canopy kit, hardware pack and mounting plate and set aside.

COLOR SELECTABLE LED EXIT SIGN

SAFETY AND INSTALLATION INSTRUCTIONS

- Remove the mounting hole plug on the top or either side of the frame.
- Place the canopy nose through the mounting hole until the side of the frame touches the canopy.
- Lock the frame onto the canopy by sliding the frame in a direction parallel to the canopy length toward the narrow end of the mounting hole.
- Slide the frame until both snaps engage the canopy nose preventing any motion back out of the hole.
- Feed the red and white wires through the center of the mounting canopy hole.
- Remove the side mounting hole on the right side. Knockout the lamp head mounting hole on the left side with a flathead screwdriver.
- Feed the blue and yellow lamp head wires through side lamp head mounting hole (Step 1).
- Attach the first lamp head to housing by aligning tabs on the lamp head assembly to the lamp head mounting slots on frame of housing (Step 2).
- Gently twist the lamp head clockwise to lock into place. An audible click should be heard. Repeat to install the remaining lamp head.
- Feed the lamp head wires in the appropriate wire channel and connect the lamp head leads to the exit sign lamp board.
- Ensure fixture leads are fed through mounting canopy and connect to AC power leads coming into the junction box.
- Connect the RED lead to the HOT wire of the power supply from 120-277V. Connect the WHITE lead to the NEUTRAL of the supply.
- Secure the canopy to the steel mounting plate using the screws provided and fasten to the junction box.
- Toggle the switchable button to select GREEN, if applicable (see Fig. C).
- Connect the battery only after continuous AC power can be provided to the unit.
- Remove the knockout chevron(s) on the faceplate(s), as needed.
- Insert the RED (or GREEN) lens into faceplate (RED – see Fig. A or GREEN – see Fig. B).
- Be sure to keep all wires out of the way of the EXIT letters to eliminate shadows when illuminated.
- Secure faceplate(s) to housing.

Wall Mount

- Remove the faceplate(s) and lenses from housing and set aside (see Fig. A).
- Drill out the appropriate mounting pattern and the wire pass hole in the backplate to fit the junction box being used.
- Feed the red and white wires through the center of the backplate.
- Remove the side mounting hole on the right side. Knockout the lamp head mounting hole on the left side with a flathead screwdriver.
- Feed the blue and yellow lamp head wires through side lamp head mounting hole (Step 1).
- Attach the first lamp head to housing by aligning tabs on the lamp head assembly to the lamp head mounting slots on frame of housing (Step 2).
- Gently twist the lamp head clockwise to lock into place. An audible click should be heard. Repeat to install the remaining lamp head.
- Feed the lamp head wires in the appropriate wire channel and connect the lamp head leads to the exit sign lamp board.
- Ensure fixture leads are fed through mounting canopy and connect to AC power leads coming into the junction box.

COLOR SELECTABLE LED EXIT SIGN

SAFETY AND INSTALLATION INSTRUCTIONS

- Connect the RED lead to the HOT wire of the power supply from 120-277V. Connect the WHITE lead to the NEUTRAL of the supply.
- Fasten the backplate to the junction box.
- Toggle the switchable button to select GREEN, if applicable (see Fig. C).
- Connect the battery only after continuous AC power can be provided to the unit.
- Remove the knockout chevron(s) on the faceplate, as needed.
- Insert the RED (or GREEN) lens into faceplate (RED – see Fig. A or GREEN – see Fig. B).
- Be sure to keep all wires out of the way of the EXIT letters to eliminate shadows when illuminated.
- Secure faceplate to housing.

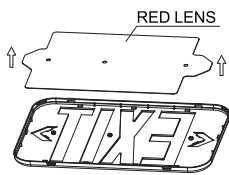
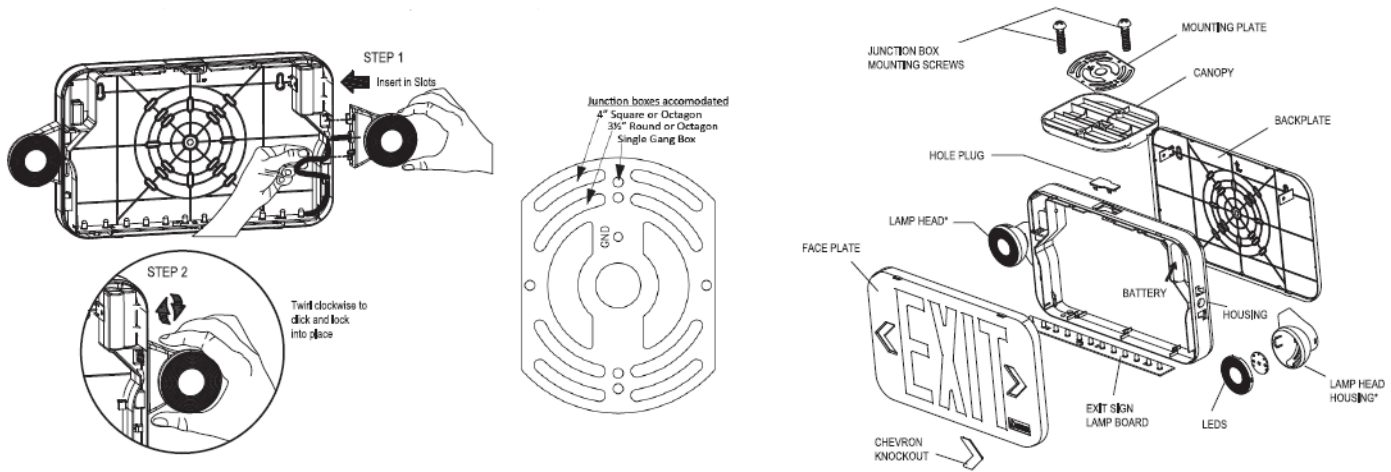

Remove or re-insert the red lens from/to face plate.

Fig.A

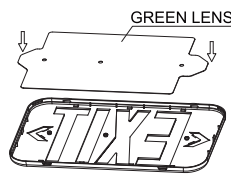

Secure the green lens to face plate.

Fig.B

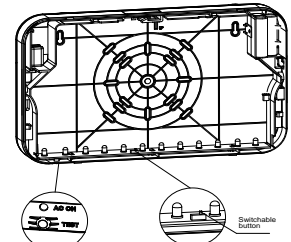

Toggle the switchable button to choose red or green illumination.

Fig.C

NOTE: The fixture ships standard with the toggle switch in the RED position.

COLOR SELECTABLE LED EXIT SIGN

SAFETY AND INSTALLATION INSTRUCTIONS

Wiring Diagram

Exit/Emergency Combo

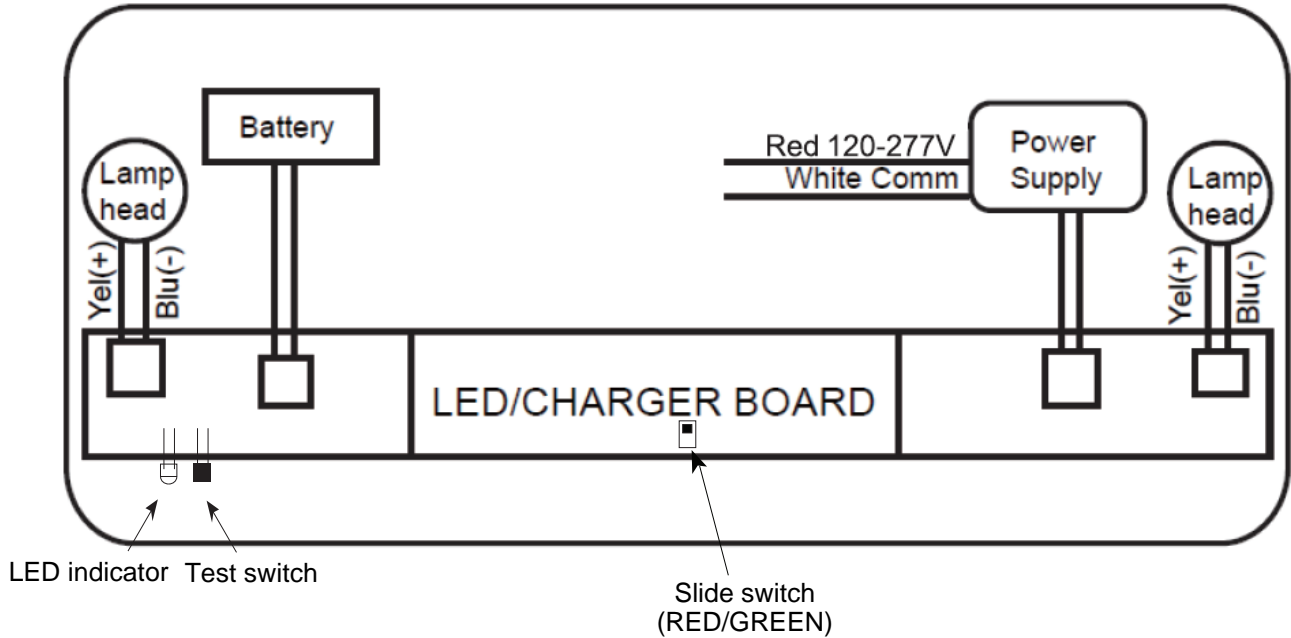

LED Status Indicator Key and Troubleshooting

Visual Status	Indication	Troubleshooting / Action to Take
UNLIT	<ol style="list-style-type: none"> Battery connection is not made. Battery has been diagnosed as dead or defective after 24 hours on continuous charging with AC power supplied. AC power has not been supplied. 	<ol style="list-style-type: none"> Make connection; or if battery is connected, disconnect battery for eight seconds and reconnect. Replace the battery. Supply AC power.
RED	Battery is connected, AC power has been supplied and fixture is in charging state.	This is the normal state. No action required.